

Detail 01

Ytong Plaster Internal 5 mm

Ytong Lambda YQ, 500 mm

Ytong Plaster External 10 mm

Marble 10 mm

Mortar, 5 mm

Reinforced Concrete, 100 mm

PVC Separation Membrane

Mineral Wool Insulation, 100 mm

2x Bitumen Waterproofing, 2x4mm

Leveling Concrete, 100 mm

Concrete Tail, 500x500x60mm

2%

Glass Foam

-1.400m

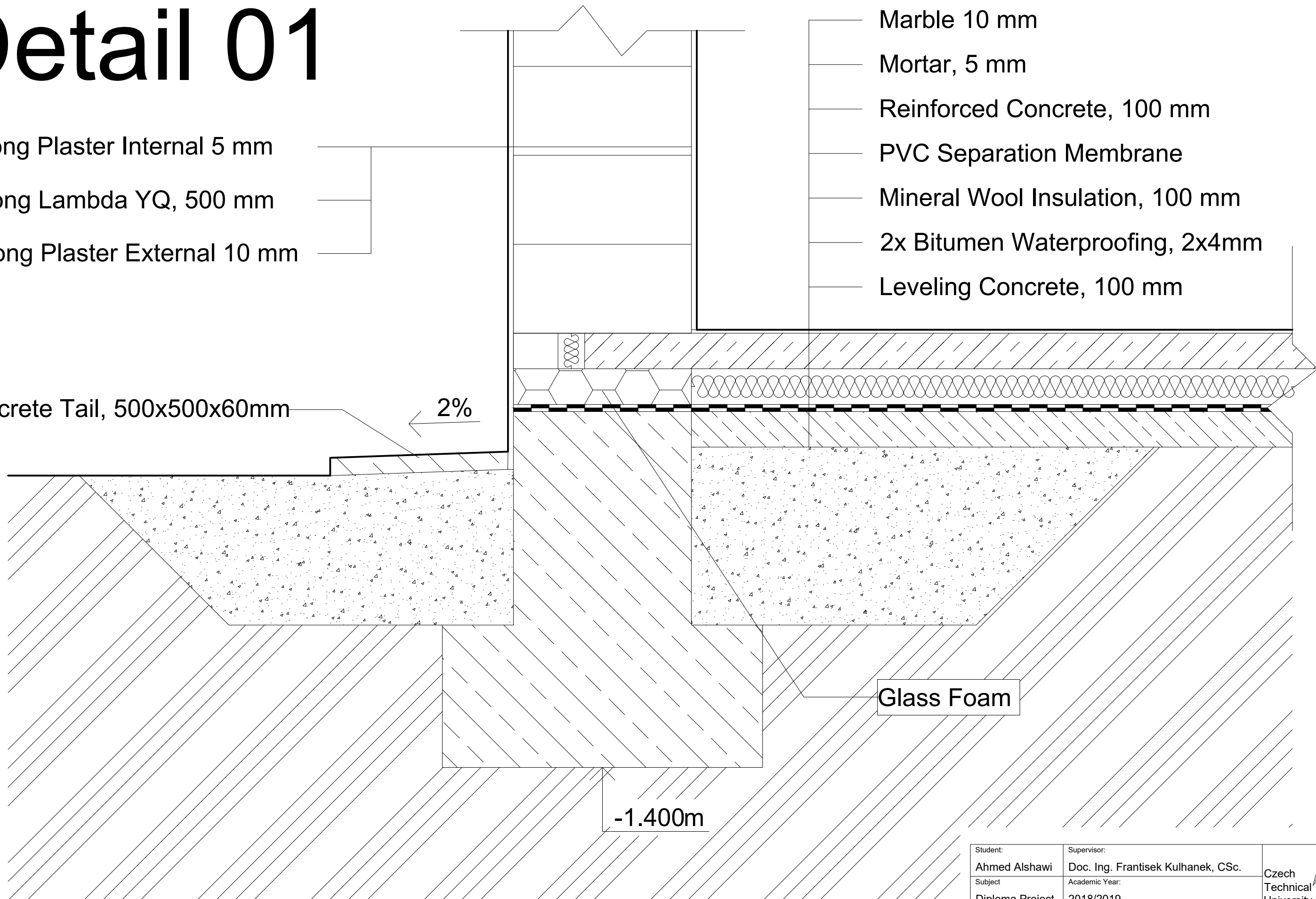

Student:	Ahmed Alshawi	Supervisor:	Doc. Ing. Frantisek Kulhanek, CSc.	Czech Technical University in Prague	
Subject:	Diploma Project	Academic Year:	2018/2019		
Title:	Detail 01			Scale:	1:10
				No. of Drawing:	07