

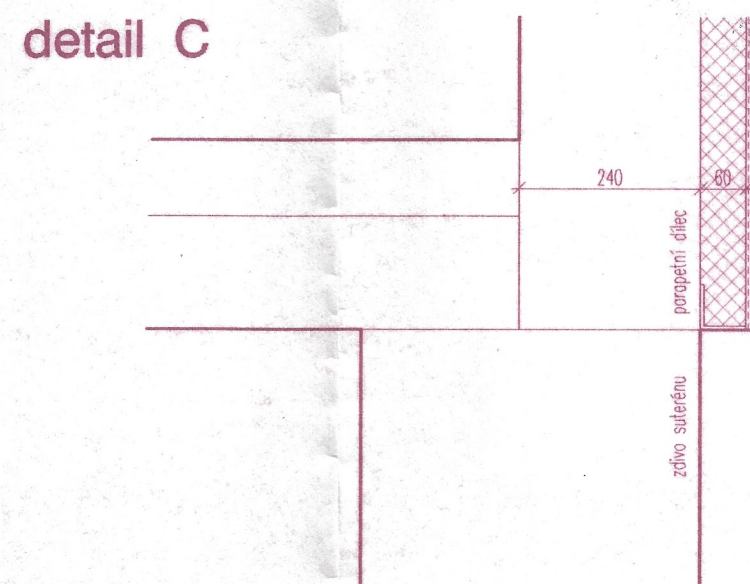

detaily zateplení 1:10

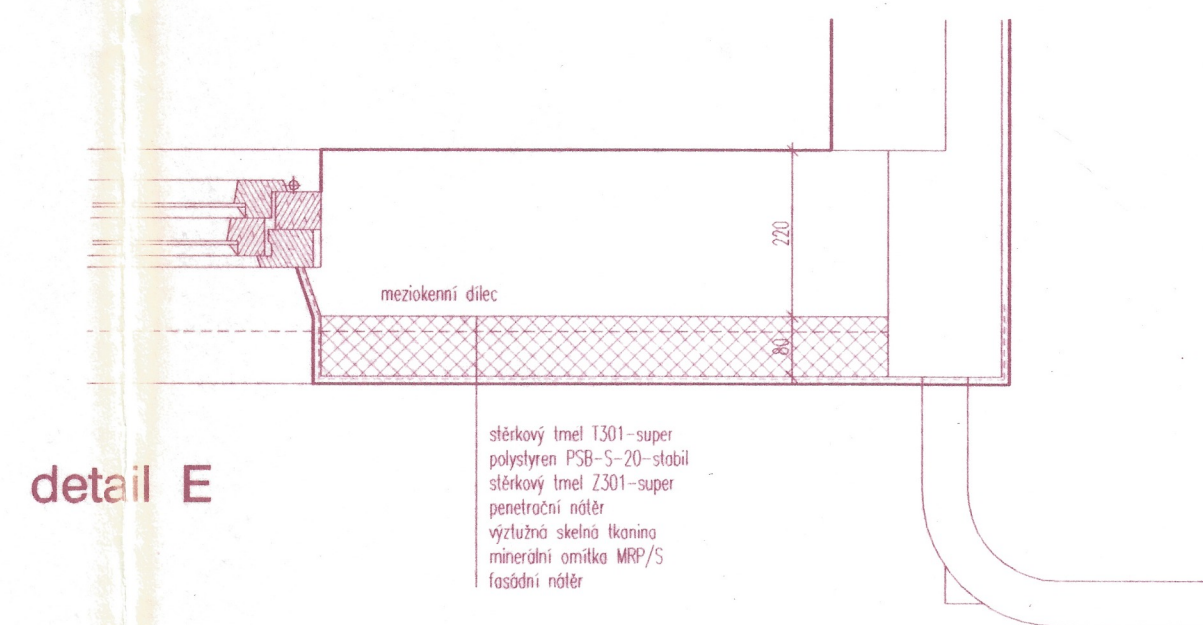
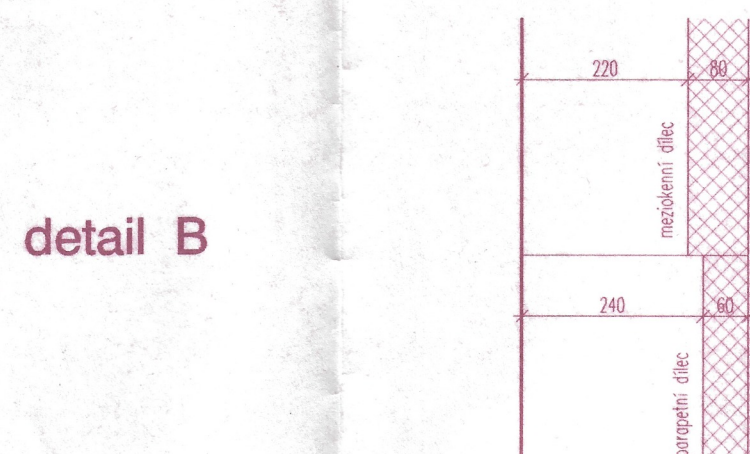
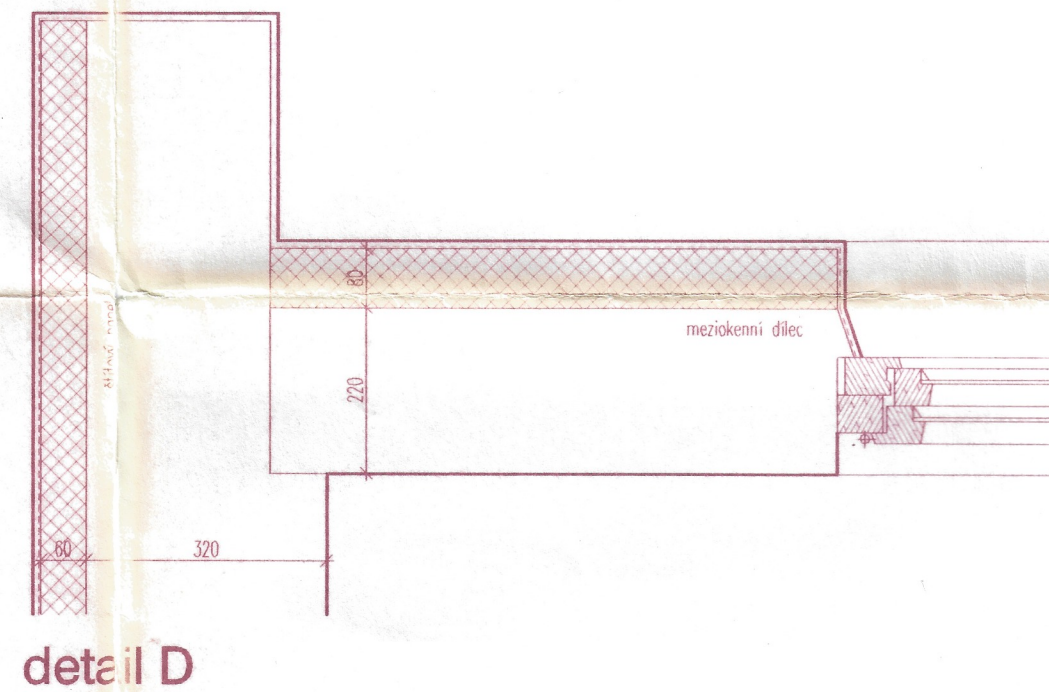
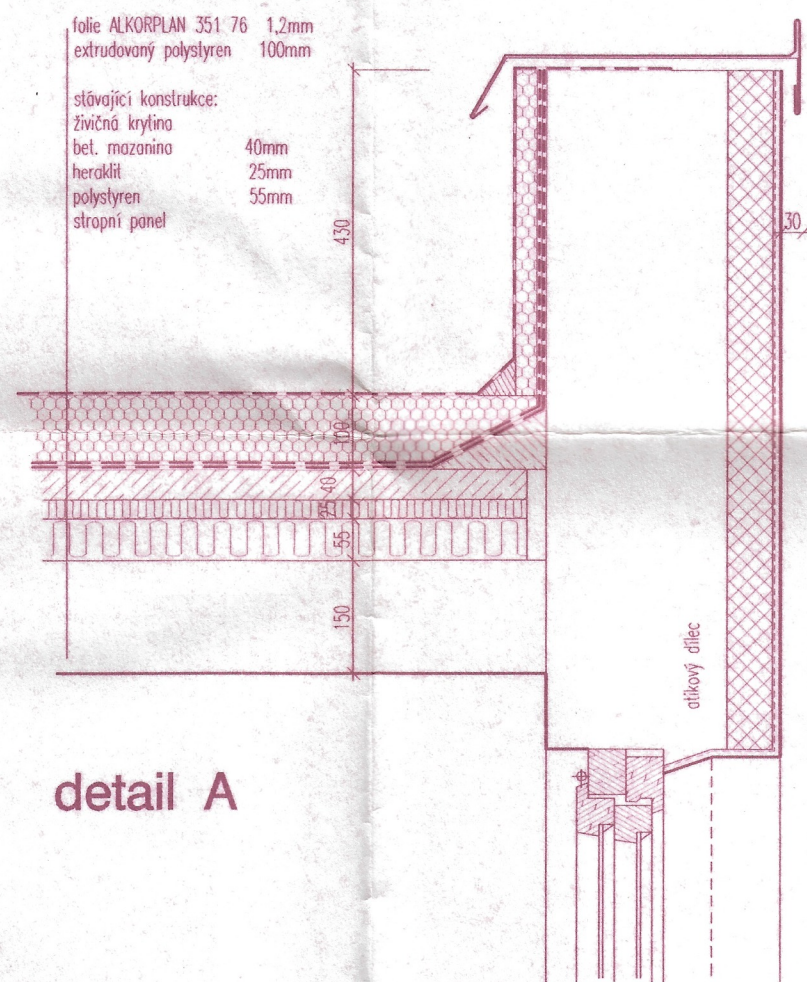

ved. proj.	ing. M. Steňko	 SM-INVEST STAVBY A ŽIVNOSTI
projektant	ing. Josef Rápek	
investor	Bytové družstvo B2	
Rekonstrukce a zateplení bytového domu Havlíčková 4161-63, Chomutov		datum 1/98 c. zak. 44-97
DETAILY ZATEPLENÍ		stupeň dokumentace pro stavební povolení
4		1 : 10 A 08