

719/8 ACE/P4A

Dimensions

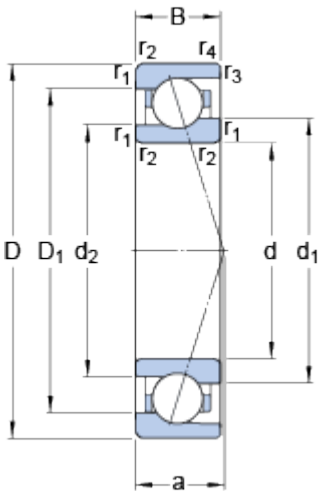

d	8	mm
D	19	mm
B	6	mm
d ₁	11.3	mm
d ₂	10.76	mm
D ₁	15.7	mm
r _{1,2}	min. 0.3	mm
r _{3,4}	min. 0.15	mm
a	6.5	mm

Abutment dimensions

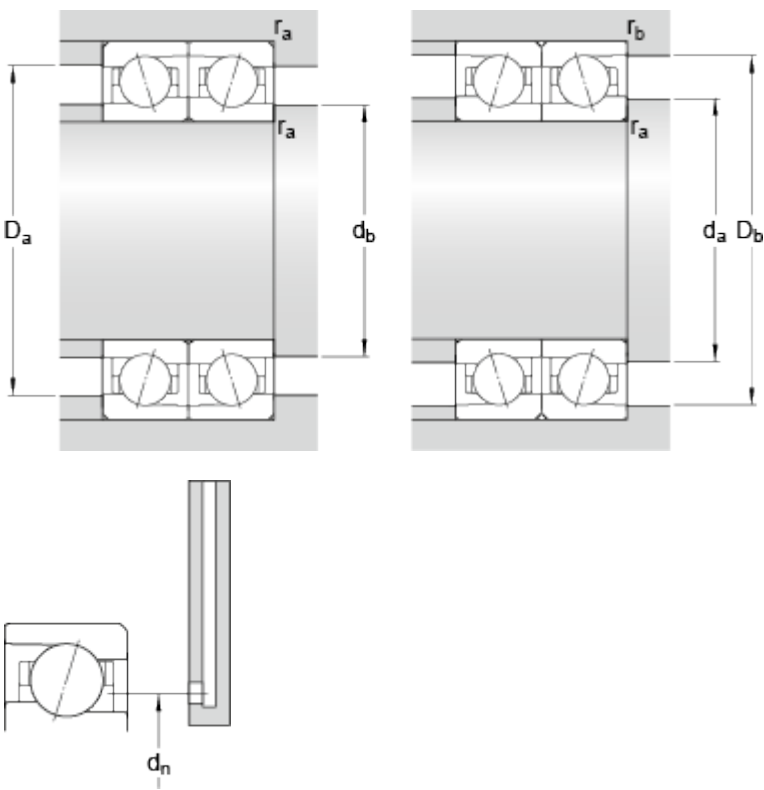

d _a	min. 10	mm
d _b	min. 10	mm
D _a	max. 17	mm
D _b	max. 18.2	mm
r _a	max. 0.3	mm
r _b	max. 0.15	mm
d _n	12.2	mm

Calculation data

Basic dynamic load rating	C	1.68	kN
Basic static load rating	C ₀	0.6	kN
Fatigue load limit	P _u	0.026	kN
Attainable speed for grease lubrication		109000	r/min
Attainable speed for oil-air lubrication		165000	r/min
Ball diameter	D _w	3.175	mm
Number of balls	z	9	

Reference grease quantity	G_{ref}	0.09	cm ³
Preload and stiffness (back-to-back, face-to-face)			
Preload class A	G_A	15	N
Static axial stiffness, preload class A		21	N/μm
Preload class B	G_B	46	N
Static axial stiffness, preload class B		32	N/μm
Preload class C	G_C	91	N
Static axial stiffness, preload class C		41	N/μm

Calculation factors

Calculation factor	f	1.02
Calculation factor	f_1	0.99
Calculation factor	f_{2A}	1
Calculation factor	f_{2B}	1.04
Calculation factor	f_{2C}	1.07
Calculation factor	f_{HC}	1
Calculation factor	e	0.68
Calculation factor (single, tandem)	Y_2	0.87
Calculation factor (single, tandem)	Y_0	0.38
Calculation factor (single, tandem)	X_2	0.41
Calculation factor (back-to-back, face-to-face)	Y_1	0.92
Calculation factor (back-to-back, face-to-face)	Y_2	1.41
Calculation factor (back-to-back, face-to-face)	Y_0	0.76
Calculation factor (back-to-back, face-to-face)	X_2	0.67

Mass

Mass bearing	0.007	kg
--------------	-------	----