





HLAVNÍ VSTUP

Izotermy:

	0,00 C
	2,00 C
	4,00 C
	6,00 C
	8,00 C
	10,00 C
	12,00 C
	14,00 C

 13,93 C(platí pro $f, R_{si}, N = 0,792$) $T_{si}=16,40$ C; $fR_{si}=0,865$  $T_{si}=-12,94$ C; $fR_{si}=---$  $T_{si}=0,00$ C; $fR_{si}=1,000$ 

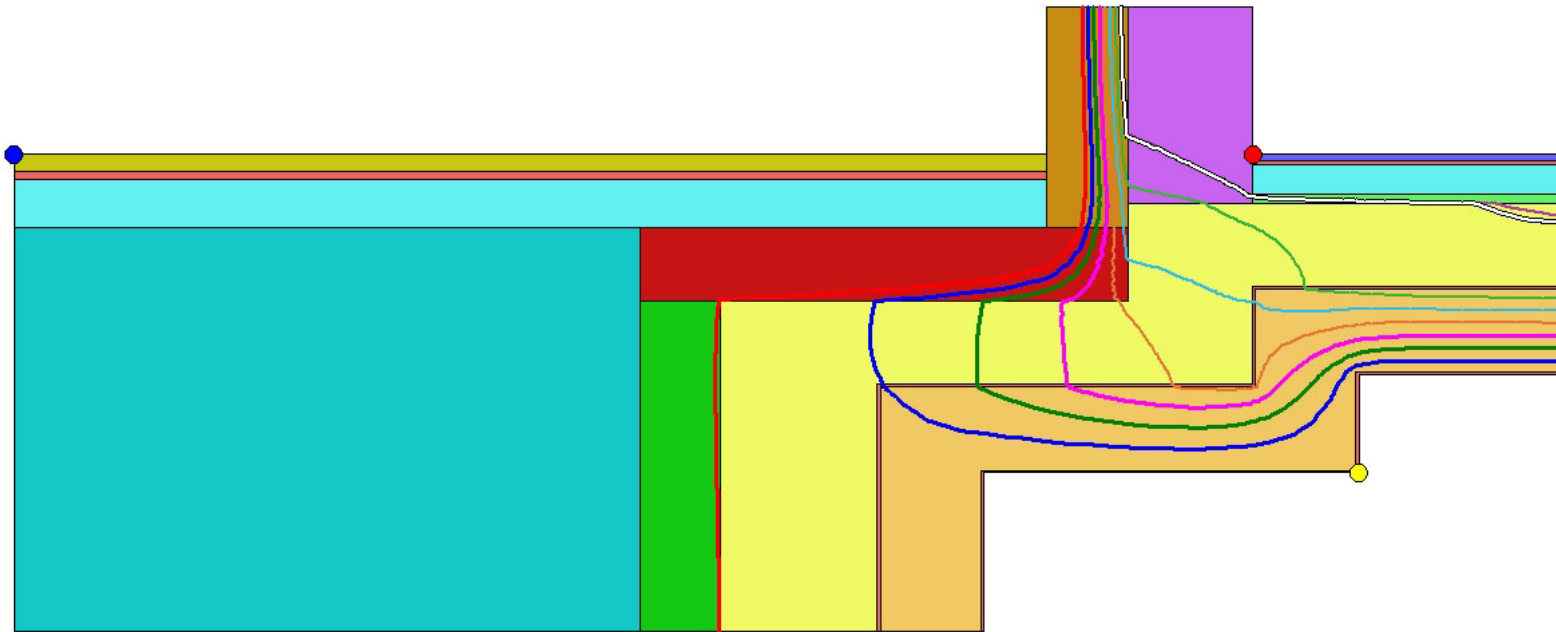
HLAVNÍ VSTUP

Teplotní pole [C]:

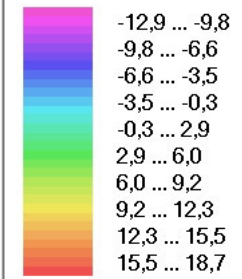

● Tsi=16,40 C; fRsi=0,865





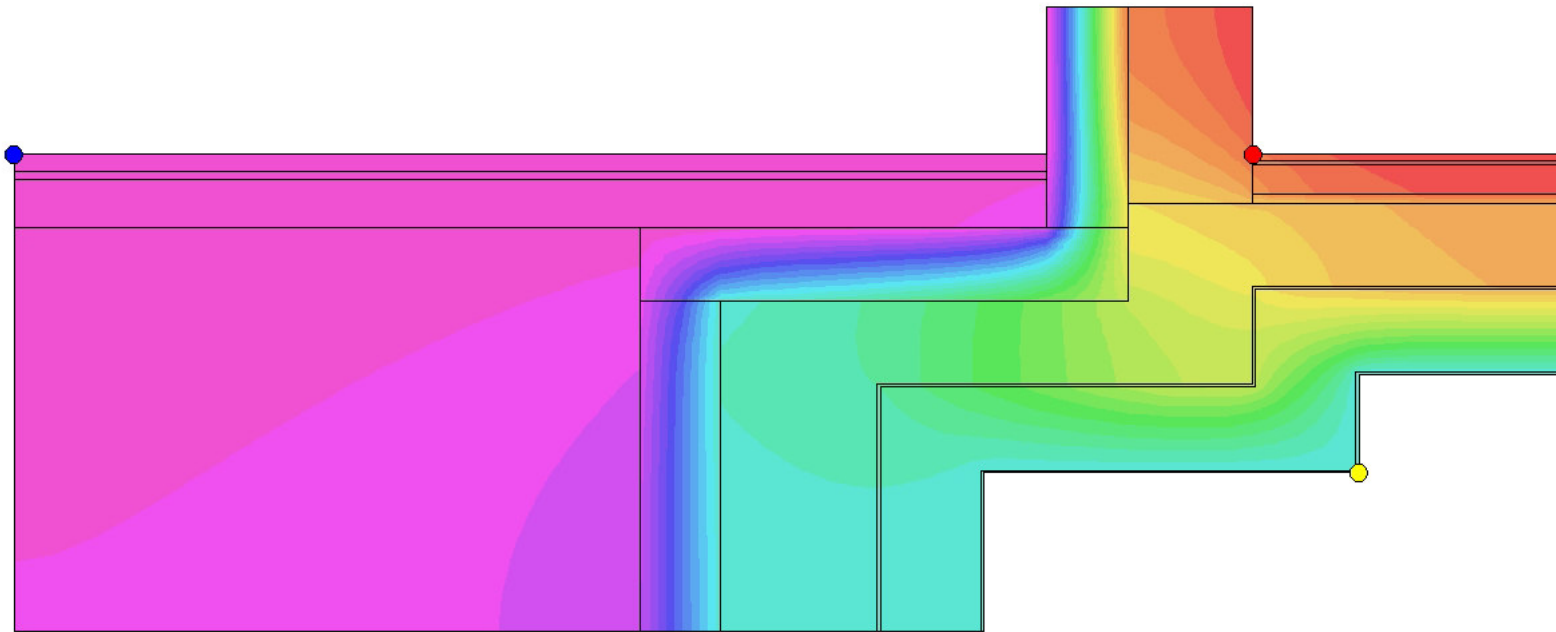



● Tsi=-12,94 C; fRsi=---



● Tsi=0,00 C; fRsi=1,000



HLAVNÍ VSTUP

Izotermy:

	0,00 C
	2,00 C
	4,00 C
	6,00 C
	8,00 C
	10,00 C
	12,00 C
	14,00 C
	13,93 C

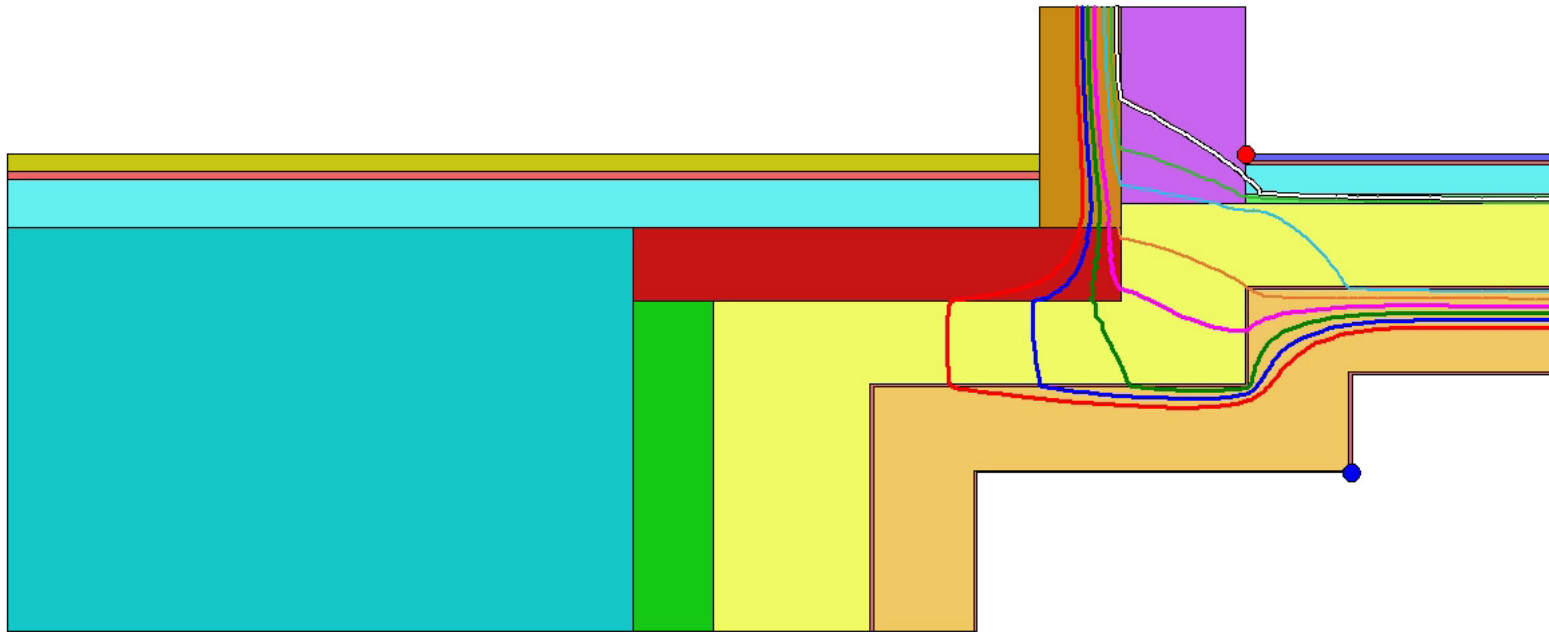
(platí pro $f, R_{si}, N = 0,792$) $T_{si}=15,25$ C; $fR_{si}=0,831$  $T_{si}=-12,99$ C; $fR_{si}=1,000$ 

HLAVNÍ VSTUP

Teplotní pole [C]:

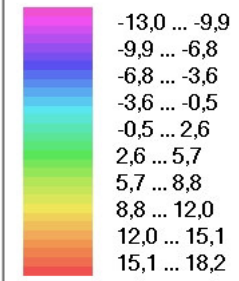

- $T_{si}=15,25$ C; $fR_{si}=0,831$
- $T_{si}=-12,99$ C; $fR_{si}=1,000$

