

AC gearmotor

KA127/TDRE225S4

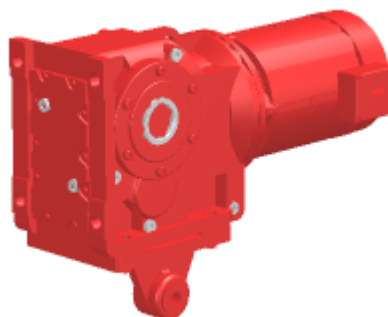

Rated motor speed	[1/min] : 1477
Output speed	[1/min] : 53
Overall gear ratio	: 27,68
Output torque	[Nm] : 6620
Service factor SEW-FB	: 1,95
input mounting position/IM	: M1A
Position of connector/terminal box	[°] : 0
Cable entry/connector position	: X
Hollow shaft	[mm] : 100
Permitted output overhung load with n=1400	[N] : 23800
Lubricant quantity 1st gear unit	[Liter] : 21
Motor power	[kW] : 37
Duration factor	: S1-100%
Efficiency class	: IE2
Efficiency (50/75/100% Pn)	[%] : 93 / 93,4 / 93
CE mark	: Yes
Motor voltage	[V] : 400/690
Wiring diagram	: R13
Frequency	[Hz] : 50
Rated current	[A] : 70 / 40,5
Cos Phi	: 0,82
Thermal class	: 130(B)
Motor protection type	: IP54
Design requirement	: IEC
Net weight	[Kg] : 700

Additional feature and Options:

T- Torque arm for shaft mounted feature