

PŘÍLOHA 4 – TECHNICKÝ LIST
VZDUCHOTECHNICKÉ JEDNOTKY BAZÉNU





Systemair GmbH Austria
 Speckbacher Str. 13
 A-6380 St. Johann / Tirol
 Phone . .
 Fax . . .
 Internet **www.systemair.at**

2021-05-14 Page 1 / 7
 Offer **202100434**
 Position **10-2 (LV)**
 From date **2021-05-03**

[PrgDbVer: 03.03.004] Contact person:
 e-mail

Tecnical data sheets

Serie	KA	Sealevel	250 m
Execution	External unit	air density	1,16 kg/m3
Heat pump included			
Typ			

Supply air		General data	
Unit size	DPH 025	<u>Casing:</u>	
Airflow [m³/h]	2 100	1,26 m/s	wallthickness casing [mm] 50,0
Length [mm]	4 375,0		Panel inside galvanized coated 0,75 mm
Width [mm]	780,0		Panel inside bottom galvanized coated 0,75 mm
Height [mm]	780,0	Surface [m2]	Panel outside galvanized coated 0,75 mm
Weight [kg]	171,00	5,55	Material guides, ec. galvanized coated

Intake / Outlet section		335,0 mm	1,03 m²	34,00 kg	3 Pa
RTVE	door type: Door with hinge on side: in air dir. right	lock type: Turn-bolt	Dimensions [mm] 265,0 x 680,0		
Opening:	air type OD	Dimensions [mm] 680,0 x 680,0			
<u>Damper:</u>	Type FRI-JS-AL/AL	Dimensions [mm]	580,0 x 660,0 x 125,0 SP20		
Internally	Yes	drive position	Internal	Pressure drop [Pa]	3
torque	1,310 Nm				
<u>Flexible canvas</u>			Dimensions [mm]	680,0 x 660,0 x 150,0 SP20	
Type FRI-ST	Material	GI	Temperature [°C]	80,00	
<u>Damper actuator</u>	NM24A-SR	Mode	modulating	Volt [V]	1x24
Quantity	1	torque [Nm]	10,000	Protection	IP54
Spring return	No	auxiliary contact	No	Delivery mode	Mounted

Filter		305,0 mm	0,94 m²	28,00 kg	110 Pa
<u>Panel filter</u>			Clean dP [Pa]	60	Dirty dP [Pa] 160
Manufacture	FAB-del	Cells pcs x size		1 x 592,0 x 592,0 x 96,0	
Medium	FZ MP SC - F7 Glasfiber				
Class	F7				
Class ISO 16890	ePM1 55%				
Efficiency ISO 16890	Filter surface [m2] 11,00				
GI-C		Guides			
1	Pcs	differential pressure switch, Mounted			
RTVE	door type: Door with hinge on side: in air dir. right	lock type: Turn-bolt	Dimensions [mm] 565,0 x 680,0		



Tecnicl data sheets

Empty section	335,0 mm	0,85 m²	11,00 kg	Pa
Opening:	air type ND	Dimensions [mm] 680,0 x 265,0		

Empty section	560,0 mm	1,73 m²	34,00 kg	Pa
RTVE	door type: Door with hinge on side: in air dir. right	lock type: Turn-bolt	Dimensions [mm] 490,0 x 680,0	
1	Pcs Tuerfeststeller Revisionstuere, Mounted			

Plate exchanger - diagonal	1 045,0 mm	4,76 m²	102,00 kg	243 Pa
Type	SGZ050/-L/0680/BS-070			Bypass length [mm] 150,0
<u>Winter condition</u>				
Exhaust	[m³/h] 1,45 m/s	Dp: 227 Pa		
Entering	30,00 [°C] 50,0 %			
Leaving	16,70 [°C] 100,0 %			
Supply	[m³/h] 2,90 m/s	Dp: 243 Pa		
Entering	6,00 [°C] 99,0 %	H t = 63,5 %		
Leaving	22,60 [°C] 33,8 %	H x = 69 %		
capacity dry	kW	capacity humid	11,80 kW	
condense water qty.	4,00 kg/h			
Recovery temperature	22,60 °C			
Twin exchanger				
Recovered capacity EN308 (5/25°C)	10,53 kW			

GI-C	Guides				
<u>Damper actuator</u>	NM24A-SR	Mode	modulating	Volt [V]	1x24
Quantity	1	torque [Nm]	10,000	Protection	IP54
Spring return	No	auxiliary contact	No	Delivery mode	Mounted
sealed cut surfaces, painted framework, Mounted					
<u>Drain pan</u>	TWPT	AL	Dimensions [mm]	680,0 x 355,0 x 35,0	
connection on opost side	No		connection size	28,0 mm	Syphon Yes

Empty section	495,0 mm	1,11 m²	24,00 kg	9 Pa	
RTVE	door type: Door with hinge on side: in air dir. right	lock type: Turn-bolt	Dimensions [mm] 455,0 x 680,0		
1	Pcs Tuerfeststeller Revisionstuere, Mounted				
Opening:	air type ND			Dimensions [mm] 680,0 x 265,0	
<u>Damper:</u>	Type	FRI-JS-AL/AL	Dimensions [mm]	580,0 x 225,0 x 125,0 SP20	
Internally	Yes	drive position	Internal	Pressure drop [Pa]	9
torque	0,440 Nm				
<u>Damper actuator</u>	NM230A	Mode	on/off	Volt [V]	1x230
Quantity	1	torque [Nm]	10,000	Protection	IP54
Spring return	No	auxiliary contact	No	Delivery mode	Mounted



Tecnicl data sheets

Heating coil	260,0 mm	0,58 m²	33,00 kg	23 Pa
Airflow [m ³ /h]	2 100	Medium	R410A	
air velocity [m/s]	1,89	Medium	4,700 l	
Air in [°C]	22,60	33,8 %	Condensing temp. [°C]	45,00
Air out [°C]	32,75	18,7 %	Med. pres. drop [kPa]	2,4
Capacity [kW]	7,00			
KO-30x26-g-3R-2,50P-515,0A-600,0H-18T-3NC-1 circuitK	standard exchanger: No	connection side:	2	
> > Connection in	22 mm	Out	22 mm	
connection type	solded 90° in counter air direction			
GI-C	Guides	Tubes	Fins	Frames
		CU	AL	AL
			Header	CU

Plug fan	550,0 mm	1,23 m²	38,00 kg	Pa
Fan	EC - PAEBM K3G280-PS10-J3	Motor	M3G084FA IE4 B30	
External press [Pa]	200 / 2 100 m³/h	Protection	IP54 / F	
Dyn. pres. [Pa]	56	Motor base data	3x400 V / 50 Hz / Default	
Tot. pres. [Pa]	664	Power [kW]	1,050	
act.press.drop [Pa]	719	Speed [1/m]	3 400	
sound power	80,9 dB(A)	Current [A]	1,60	
Speed [1/m]	2 791	Absorb. power	0,608 kW	
Fan shaft power [kW]	0,510	SFP Class, validation	968 [W/(m³/s)]	SFP3
efficiency %	60,16	SFP Class, selection	1 040 [W/(m³/s)]	SFP3
Fan outlet [mm]	315,0 x 315,0	Antivibration insulators	No	
k-Value (d=1.2 kg/m ³)	77	Control voltages	7,19 V	
Fan octave band sound power level (Lokt) [dB]				
dB(A) Frq. Hz 63 125 250 500 1k 2k 4k 8k				
73,4	Inlet	64,6	66,1	72,4
80,0	Outlet	73,1	70,0	77,4
		75,9	75,0	73,4
		69,8	66,9	65,5
		64,8	63,2	67,0
GI-C	Fan-motor-base frame			
The fan system effect is taken into account in the fan performances.				
1	Pcs	Pressure outlet tabs for air flow measurement, Mounted		
RTVE	door type: Door with hinge	lock type: Turn-bolt	Dimensions [mm] 490,0 x 680,0	
	on side: in air dir. right			
1	Pcs	Tuerfeststeller Revisionstuere, Mounted		



Tecnicl data sheets

Heating coil	230,0 mm	0,52 m²	24,00 kg	20 Pa
Airflow [m ³ /h] 2 100	Medium	Antifrogen L		
air velocity [m/s] 1,89	Medium	3,900 l	0,1600 l/s	0,25 m/s
Air in [°C] 15,00 50,0 %	Med. in [°C] 70,00			
Air out [°C] 34,00 16,0 %	Med out [°C] 50,00			
Capacity [kW] 13,09	Med. pres. drop [kPa] 5,92			
max. heating cap. [kW] 17,24				
HR-30x26-g-2R-2,00P-525,0A-600,0H-18T-6NC	standard exchanger: No	connection side:		1
Connection in 1 0/0 " Out 1 0/0 "	Tubes CU	Fins AL	Frames AL	Header CU
connection type Screwed, Straight, standard				
GI-C Guides				
1 Pcs antifreeze sensor HTF, Mounted				

Anti frost frame	260,0 mm	0,58 m²	23,00 kg	Pa
1 Pcs antifreeze thermostat QAF81.3, Mounted				
RWVE door type: Removable panel	lock type: Turn-lever	Dimensions [mm] 190,0 x 680,0		
on side: in air dir. right				
Opening: air type SU	Dimensions [mm] 680,0 x 680,0			
<u>Flexible canvas</u>	Dimensions [mm]	680,0 x 660,0 x 150,0 SP20		
Type FRI-ST Material GI	Temperature [°C]	80,00		

Exhaust air	General data			
Unit size DPH 025	<u>Casing:</u>			
Airflow [m ³ /h] 2 100 1,26 m/s	wallthickness casing [mm]	50,0		
Length [mm] 4 375,0	Panel inside	galvanized coated	0,75 mm	
Width [mm] 780,0	Panel inside bottom	galvanized coated	0,75 mm	
Height [mm] 780,0 Surface [m ²]	Panel outside	galvanized coated	0,75 mm	
Weight [kg] 482,00 16,78	Material guides, ec.	galvanized coated		

Filter	480,0 mm	1,48 m²	41,00 kg	64 Pa
<u>Panel filter</u>	Clean dP [Pa] 32	Dirty dP [Pa] 96		
Manufacture FAB-del	Cells pcs x size	1 x 592,0 x 592,0 x 96,0		
Medium FZ MP SC - M5 Glasfiber				
Class M5				
Class ISO 16890 ePM10 70%				
Efficiency ISO 16890 Filter surface [m²] 11,00				
GI-C Guides				
1 Pcs differential pressure switch, Mounted				
RTVE door type: Door with hinge	lock type: Turn-bolt	Dimensions [mm] 380,0 x 680,0		
on side: in air dir. left				
Opening: air type Eta	Dimensions [mm] 680,0 x 680,0			
<u>Flexible canvas</u>	Dimensions [mm]	680,0 x 660,0 x 150,0 SP20		
Type FRI-ST Material GI	Temperature [°C]	80,00		



Tecnical data sheets

Plug fan	560,0 mm	1,73 m²	45,00 kg	Pa
Fan EC - PAEBM K3G280-PS10-J3 External press [Pa] 200 / 2 100 m³/h Dyn. pres. [Pa] 56 Exhaust air Tot. pres. [Pa] 574 act.press.drop [Pa] 719 sound power 80,0 dB(A) Speed [1/m] 2 655 Fan shaft power [kW] 0,436 efficiency % 59,55 Fan outlet [mm] 315,0 x 315,0 k-Value (d=1.2 kg/m3) 77	Motor M3G084FA IE4 B30 Protection IP54 / F Motor base data 3x400 V / 50 Hz / Default Power [kW] 1,050 Speed [1/m] 3 400 Current [A] 1,60 Absorb. power 0,526 kW SFP Class, validation 940 [W/(m3/s)] SFP3 SFP Class, selection 900 [W/(m3/s)] SFP3	Antivibration insulators No Control voltages 6,79 V		
Fan octave band sound power level (Lokt) [dB] dB(A) Frq. Hz 63 125 250 500 1k 2k 4k 8k 72,2 Inlet 63,7 65,5 71,0 68,3 65,8 64,1 64,1 62,1 79,2 Outlet 70,9 68,8 77,0 74,6 74,3 72,6 68,1 66,1				
GI-C Fan-motor-base frame				
The fan system effect is taken into account in the fan performances.				
1 Pcs Pressure outlet tabs for air flow measurement, Mounted				
RTVE door type: Door with hinge lock type: Turn-bolt Dimensions [mm] 490,0 x 680,0 on side: in air dir. left				
1 Pcs Tuerfeststeller Revisionsture, Mounted				
compressor section R410A	525,0 mm	1,62 m²	83,00 kg	50 Pa
scroll-compressor ZP24K5E-TFD cooling capacity: 5,61 kW heating capacity: 7,00 kW current: 3,03 A power input: 1,60 kW max. current: 4,8 A				
RTVE door type: Door with hinge lock type: Turn-bolt Dimensions [mm] 455,0 x 680,0 on side: in air dir. left				
1 Pcs Tuerfeststeller Revisionsture, Mounted				
Empty section	230,0 mm	0,71 m²	14,00 kg	Pa
Plate exchanger - diagonal	1 045,0 mm	4,76 m²	102,00 kg	127 Pa



Tecnical data sheets

Cooling coil				560,0 mm	1,26 m²	56,00 kg	72 Pa
Airflow [m ³ /h]	2 100			Medium		R410A	
air velocity [m/s]	2,05			Medium		4,200 l	
Air in [°C]	16,70	100,0 %		Evaporating temp. [°C]		5,00	
Air out [°C]	13,82	100,0 %		Overheating [°C]		10,00	
Capacity [kW]	5,61			condensation temp. [°C]		45,00	
				Med. pres. drop [kPa]		20,9	
DV-30x26-g-3R-2,50P-475,0A-600,0H-18T-2NC-1 circuitKK				standard exchanger:	No	connection side:	1
> > Connection in	12 mm	Out	22 mm	Tubes	Fins	Frames	Header
connection type	solded 90° in counter air direction			CU	AL	AL	CU
air-side humid press.drop				66 Pa		air-side dry press.drop	
				26 Pa			
AL Guides							
droplet separator separately extendable, Mounted							
<u>Drain pan</u>	TWK	AL		Dimensions [mm]	680,0 x 405,0 x 35,0		
connection on opost side	Yes			connection size	28,0 mm	Syphon	Yes
<u>Drip eliminator</u>				Quality frame	STST	Quality fins	PVC
							6 Pa
Circular air				335,0 mm	0,75 m²	16,00 kg	2 Pa
Opening:		air type RC		Dimensions [mm] 680,0 x 265,0			
<u>Damper:</u>	Type	FRI-JS-AL/AL		Dimensions [mm]	680,0 x 225,0 x 125,0 SP20		
Internally	No			drive position	External	Pressure drop [Pa]	2
torque	0,550 Nm						
<u>Damper actuator</u>	NM24A-SR			Mode	modulating	Volt [V]	1x24
Quantity	1			torque [Nm]	10,000	Protection	IP54
Spring return	No			auxiliary contact	No	Delivery mode	Mounted
<u>Drain pan</u>	TWK	AL		Dimensions [mm]	680,0 x 230,0 x 35,0		
connection on opost side	No			connection size	without drain	Syphon	No
Empty section				305,0 mm	0,69 m²	16,00 kg	Pa
RTVE		door type: Door with hinge		lock type: Turn-bolt		Dimensions [mm] 565,0 x 680,0	
		on side: in air dir. left					
<u>Drain pan</u>	TWK	AL		Dimensions [mm]	680,0 x 230,0 x 35,0		
connection on opost side	No			connection size	28,0 mm	Syphon	Yes



Tecnical data sheets

Intake / Outlet section		335,0 mm	0,75 m²	31,00 kg	3 Pa
RTVE	door type: Door with hinge on side: in air dir. left	lock type: Turn-bolt		Dimensions [mm] 265,0 x 680,0	
Opening:		air type EH		Dimensions [mm] 680,0 x 680,0	
<u>Damper:</u>	Type FRI-JS-AL/AL	Dimensions [mm]	580,0 x 660,0 x 125,0 SP20		
Internally	Yes	drive position	Internal	Pressure drop [Pa]	3
torque	1,310 Nm				
<u>Flexible canvas</u>		Dimensions [mm]		680,0 x 660,0 x 150,0 SP20	
Type	FRI-ST	Material	GI	Temperature [°C]	80,00
<u>Damper actuator</u>	NM24A-SR	Mode	modulating	Volt [V]	1x24
Quantity	1	torque [Nm]	10,000	Protection	IP54
Spring return	No	auxiliary contact	No	Delivery mode	Mounted
<u>Drain pan</u>	TWK	AL	Dimensions [mm]	680,0 x 230,0 x 35,0	
connection on opost side	No		connection size	without drain	Syphon No

Indication: given makes are exemplary, given weights are curb weight
 dimensions and construction changes which are in the interest of technical progress are reserved
 attention, please announce delivery sections and splittings

	Unit base frame	FRI-FEZ20-90mm-Iso35	Mounted
	unloading by crane (if necessary adjust module lengths)		
	Casing joins sealed up on bottom		
GI-C	weatherproof roof		
1 set	Potential equalizations (for every flexible canvas 1 pcs), Pre mounted		
	weatherproof panels, Mounted		
	unit roof loose		



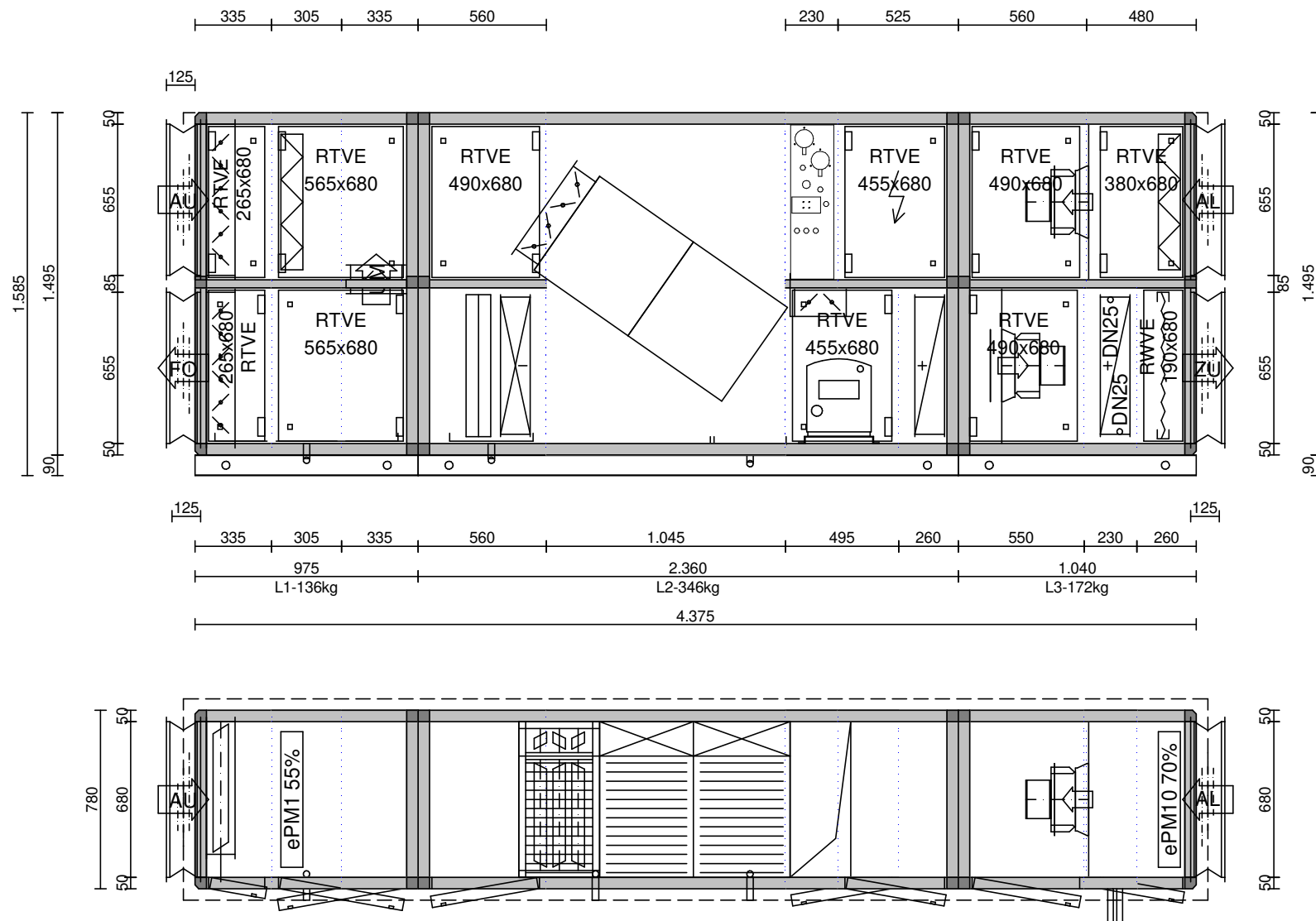

Please calculate for connections an additional space of +100 mm

RTVE	Revision door	with Turn-bolt
RTHE	Revision door	with Turn-lever
RTHI	Revision door	with Double lever
RWVE	Revision panel	with Turn-bolt
RWH	Revision panel	with Turn-lever
RTDE	Revision door	with Double bolt

PrgVer: 03.03.004 Release by:

Project	Position	
Client	Project no. 202100434	Revision no
Model unit 1	Position no. 10	Date 03.05.2021
Supply air DPH025/H50-TE, TOP	Weight ca. 655,00 Kg	Qta 1
Model unit 2	Exhaust air DPH025/H50-TE, TOP	scale 1:25



Contact person