

PRODUCED BY AN AUTODESK STUDENT VERSION

PRODUCED BY AN AUTODESK STUDENT VERSION

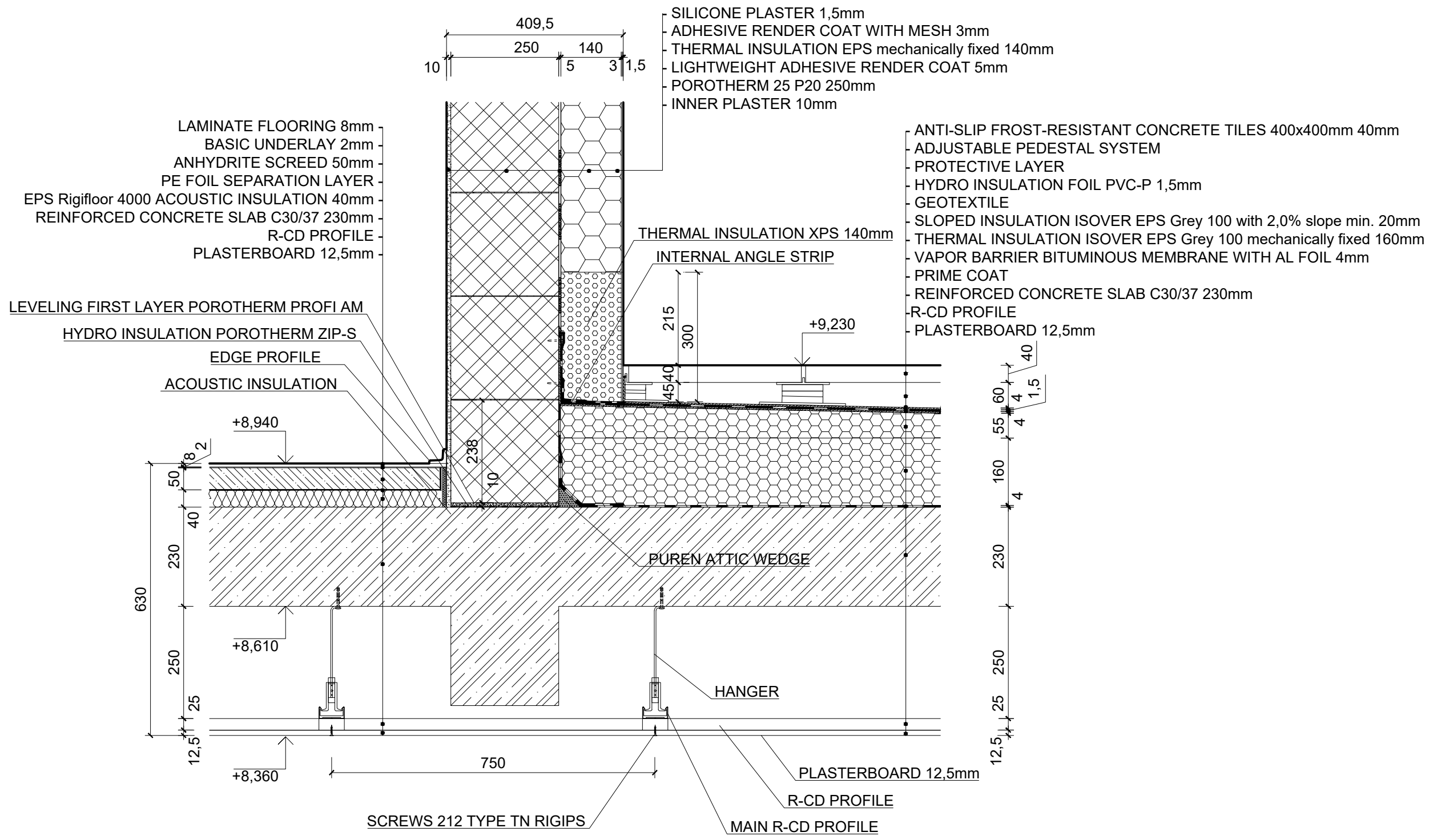

designed by Akбота Baibatyrova	supervisor Ing. Malila Noori, Ph.D.	FACULTY OF CIVIL ENGINEERING CTU	
course 124BPRO - BACHELOR PROJECT		date 05.2021	size A4
subject RESIDENTIAL BUILDING IN PRAGUE		scale 1:10	No 16
drawing D5 - DETAIL OF THE TERRACE			