

STAIRCASE :

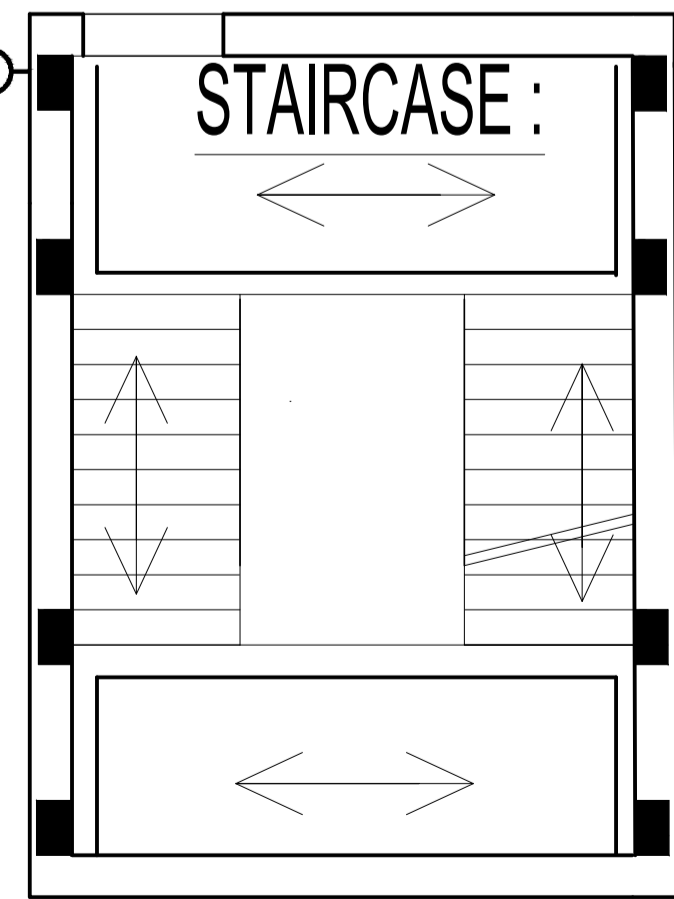
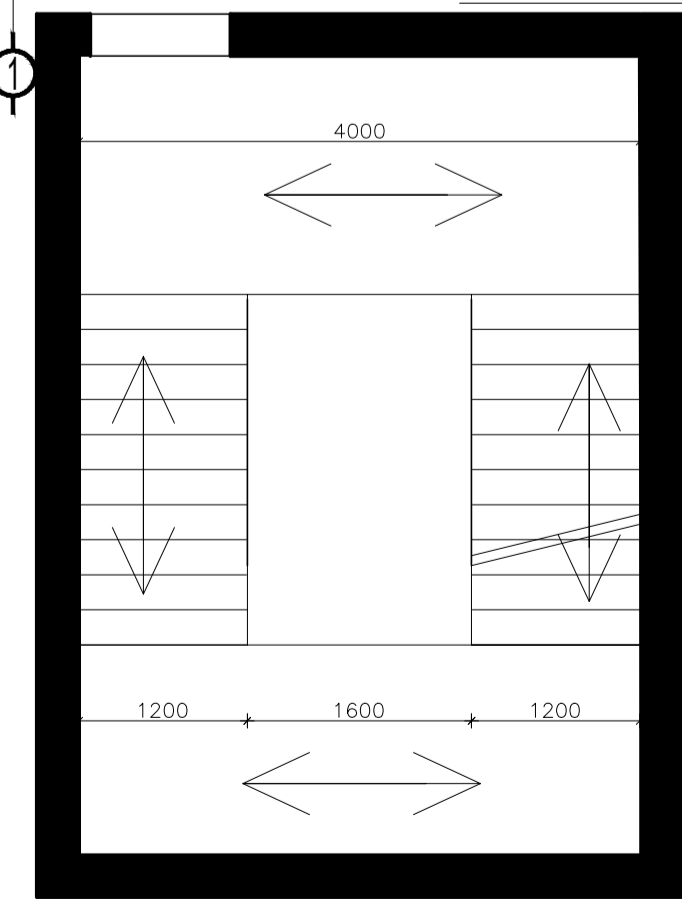

- h = 170 mm , b = 290 mm ,
- L1 = 1700 mm , L2 = 1500
- hf = 3200 mm , B = 4000 mm , SLOPE : max. 30,38 °

EXPLANATION OF THE SYMBOLS:

- ① ISI UNIT
- ② TRAPEZ BOX 150 X 300 mm
- ③ PERIMETER JOINT INSULATION AROUND
- DP DOWN PIPES OF THE RAIN
- SP SEWER PIPES

±0,000 = 189,56 m ASL

DEVELOPED BY: Bc.M. Faeyz Yosufi	CONSULTANT: Ing. Josef Novák, Ph.D	CONTROLLED: Ing. Josef Novák, Ph.D.	
DREW BY: Bc.M. Faeyz Yosufi	CUSTOMER: Faculty of Civil Engineerinf Czech technical University In Prague		
General Purpose:		PARE:	
Multifunctional building			
Attachment name: Form-work basement		Format:	4XA4
		Date:	13.10.2019
		Purpose:	building permit
		Archive Issues:	----
		Scale: 1:50	Drawing No. 05