

LEGEND:

Nr	PURPOSE OF THE ROOM	AREA [m ²]	FLOORING SURFACE	COMPOSITION
05				
05.01	ROOF	265.940	ASPHALT STRIPS	R1

FLAT ROOF - R1

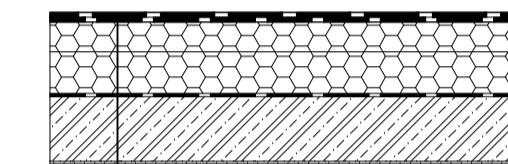

- WATERPROOFING 2x ASPHALT MODIFIED STRIPS 10 mm
- THERMAL INSULATION ISOVER EPS INCLINED 30-160 mm
- THERMAL INSULATION ISOVER EPS IN SLOPE 3% 200 mm
- VAPOR BARRIER - ASPHALT OXIDIZED STRIP 5 mm
- PENETRATION COATING
- REINFORCED CONCRETE SLAB 200 mm
- PLASTER 5 mm

LEGEND OF MATERIALS:

- REINFORCED CONCRETE C30/37
- POROTHERM 17.5 P+D
- POROTHERM 11.5 P+D P8, M2,5 - partitions
- THERMAL INSULATION ETICS (EPS)

DEFINITIONS:

- R03 ANTI-RAIN BLINDS FOR VENTILATION IMOS, 1000x400 mm
- C CHIMNEY
- V VENTILATION
- D DRAINAGE
- L LADDER
- RD1 ROOF DRAINAGE DN 100
- DRAINAGE PIPE DN 100
- VENTILATION PIPE DN 150

±0,000 = +262,450 BpV

SECTION A-A'

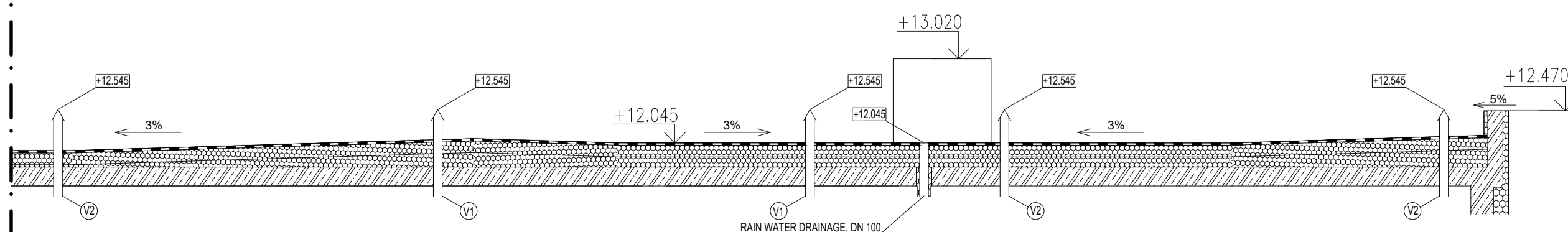

DESIGNED BY:	SUPERVISOR:	CZECH TECHNICAL UNIVERSITY IN PRAGUE 
DAYANA MURATOVA	Ing. MALILA NOORI, Ph.D.	
PART:	CONSULTED WITH:	
BUILDING STRUCTURES	Ing. MALILA NOORI, Ph.D.	
SUBJECT:	124BPRO - BACHELOR PROJECT	
OBJECT:	RESIDENTIAL BUILDING	SCALE: 1:50
		DATE: 05/2020
DRAWING:	PLAN VIEW OF THE ROOF	DRAWING N: 7