

At the entrance from northern and southern arm

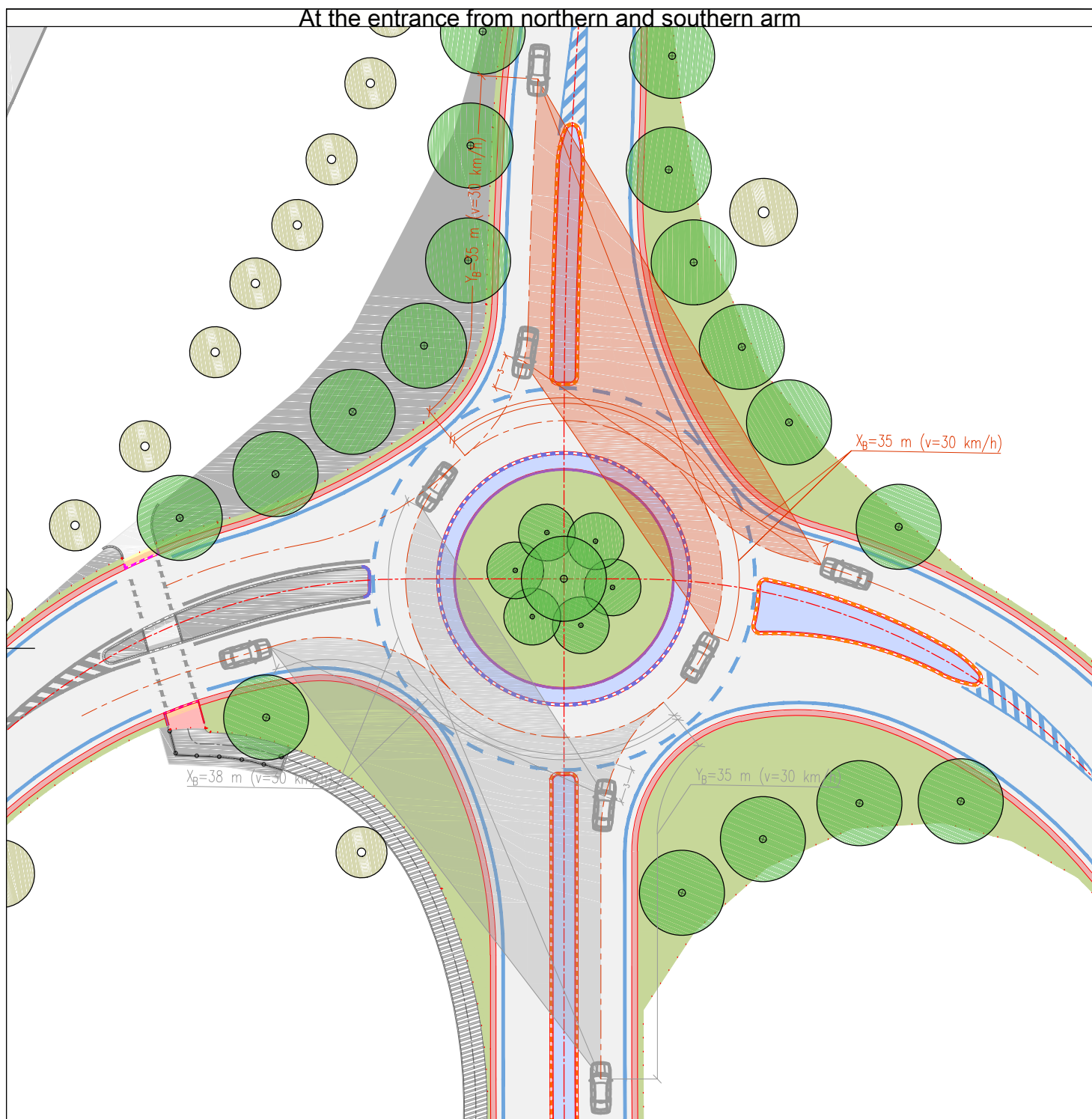

Sight distances for a place for crossing of pedestrians:

- Sight distance from waiting areas of a place for crossing the carriageway $D_v = 50$ m
- Sight distance for stopping $D_z = 35$ m
- According to ČSN 73 6110/Z1 Projecting of local roads
- According to subsection 10.1.4 - Sight distances in front of pedestrian crossings; Table 17
- Speed limit 50 km/h

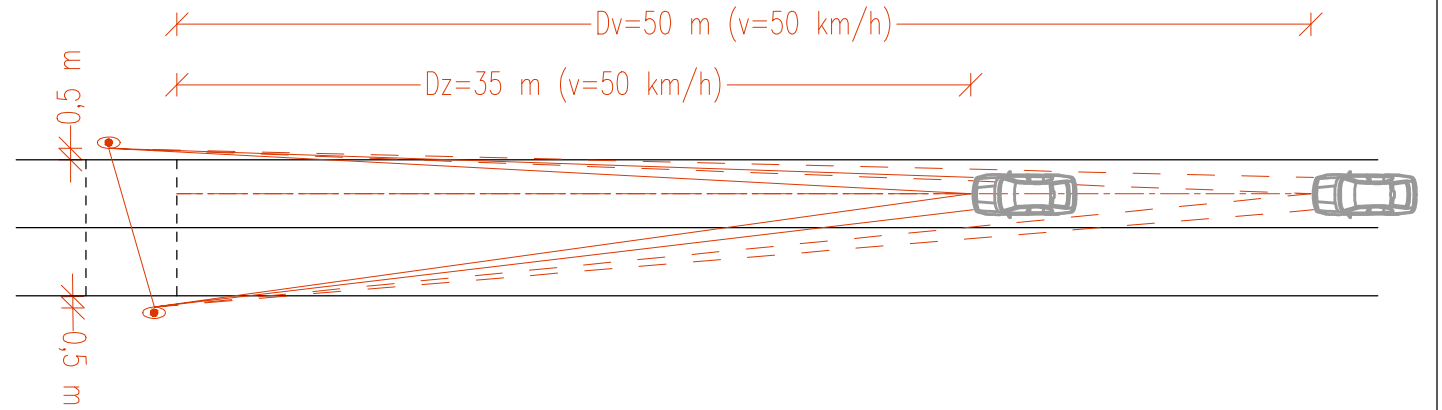

Sight distances on a roundabout with one lane on the circulatory roadway and diameter 33,5 m in rural area:

- Speed reached on the circulatory roadway 30km/h
- Built-up area and areas allowed to be build on
- Sides of sight visibility triangles $X_b = 38$ m, $Y_b = 35$ m
- In the area of sight visibility triangles cannot be any obstacles higher than 0,75 m above the level of carriageway. Allowed are occasional obstacles of a width maximally 0,15 m.
- In compliance with ČSN 73 6102 Planning of highways on highways and TC 135 Planning of roundabouts on highways and local roads (table 3, figure 15)

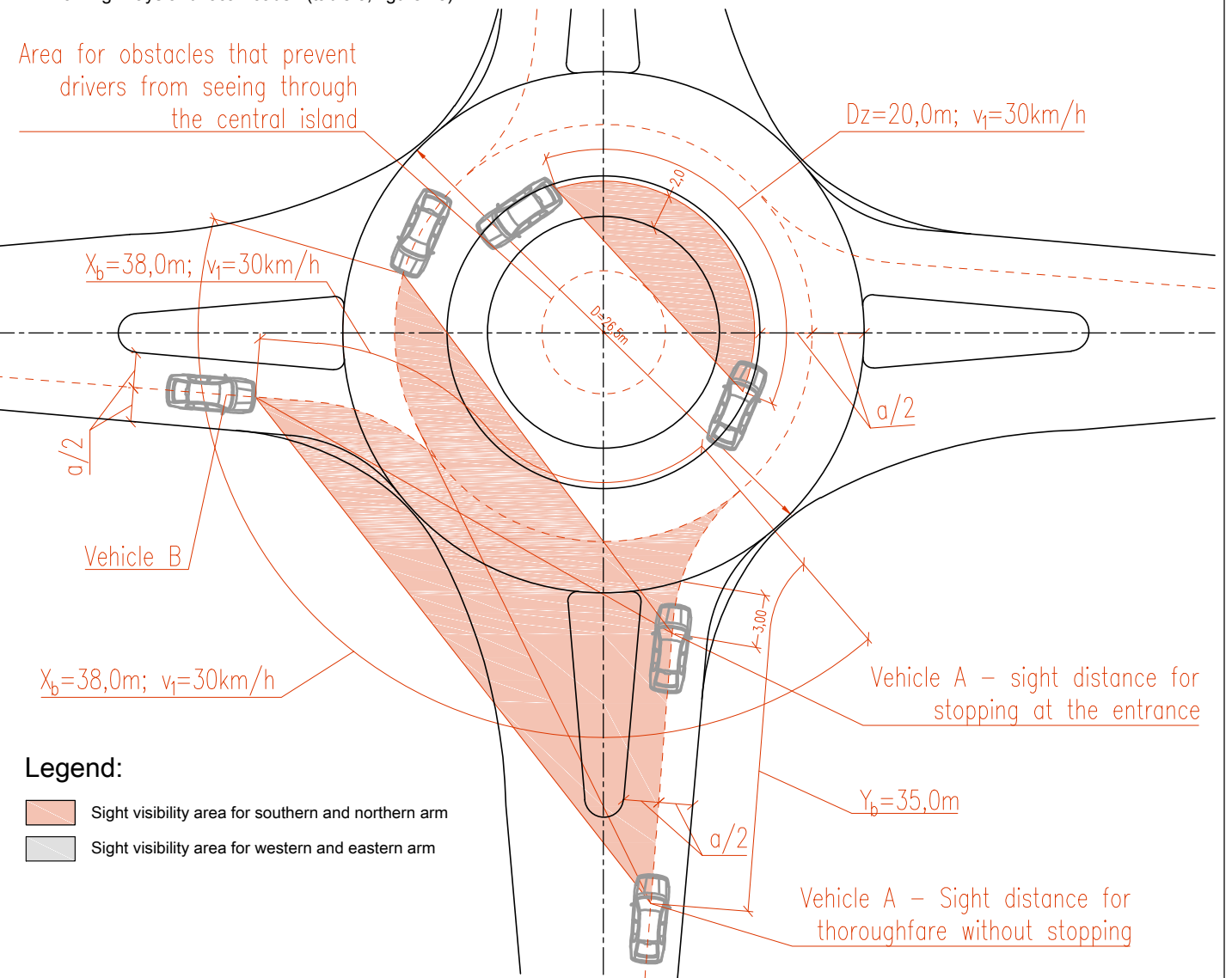

At the entrance from western and eastern arm

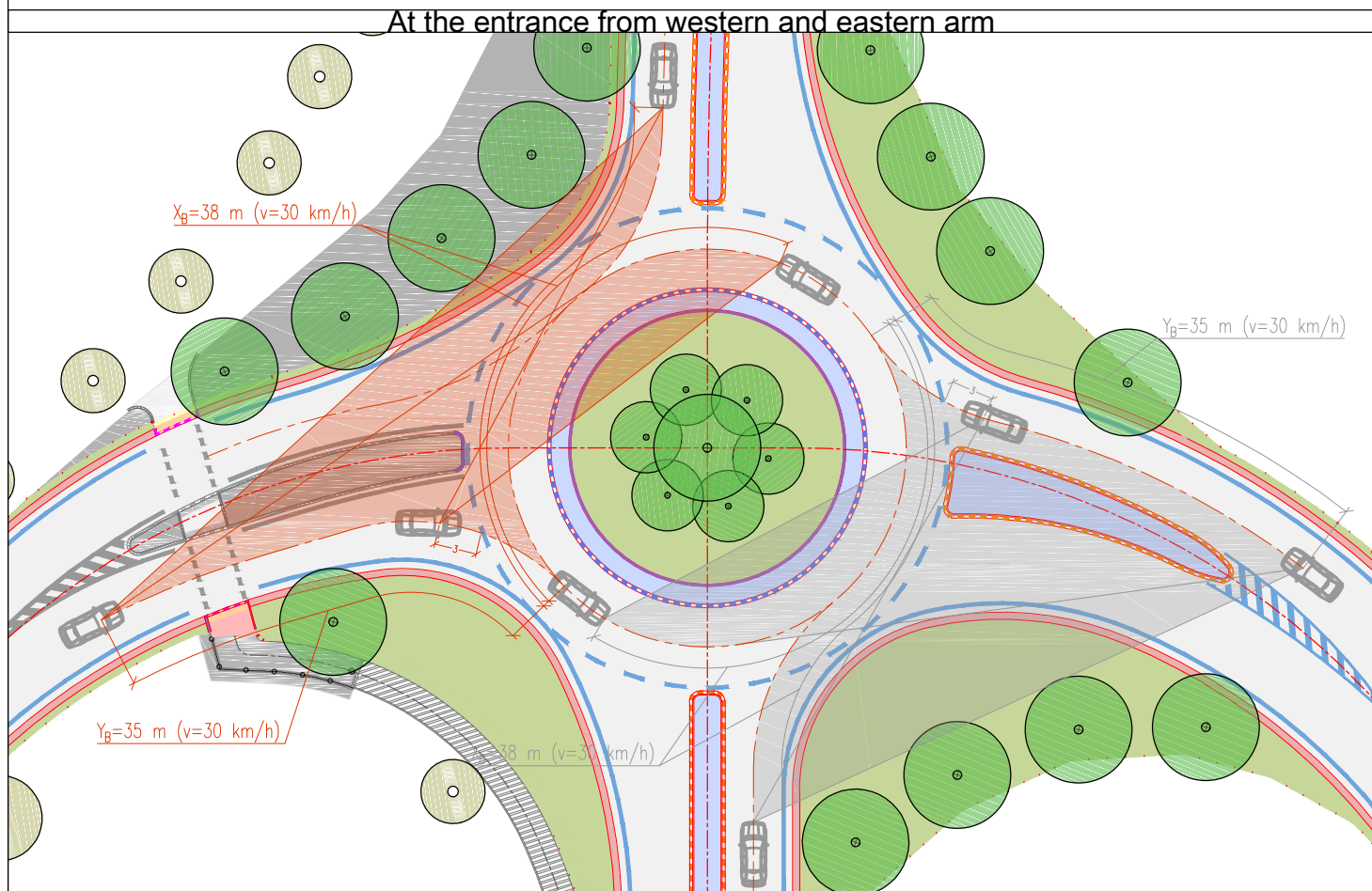

Legend:

- Sight visibility area for southern and northern arm
- Sight visibility area for western and eastern arm

At the place for crossing of pedestrians

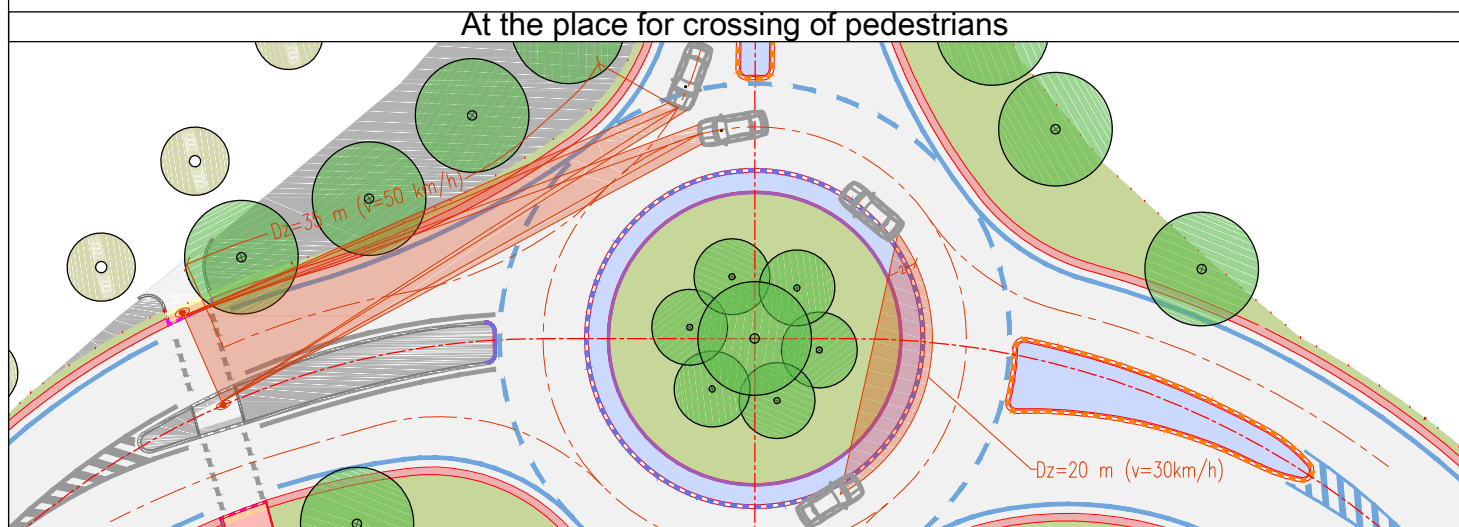

University:	Czech Technical University in Prague		
Faculty:	Faculty of Transportation Sciences		
Worked out by:	Bc. Jakub Matějček		
Supervisors:	doc. Ing. Jiří Čarský, Ph.D. Ing. Josef Filip, Ph.D.		
Date:	24. 05. 2019	Academic year:	2018/2019
		Project:	Master thesis
Title of the master thesis:	Modification of Crossroads on Roads III/0063 and III/2384 at Velká Dobrá		Amount of A4 papers: 3
Appendix:	Sight distances		Scale: 1:500
			Appendix number: 2.5

