

# Plan View Of The First Floor

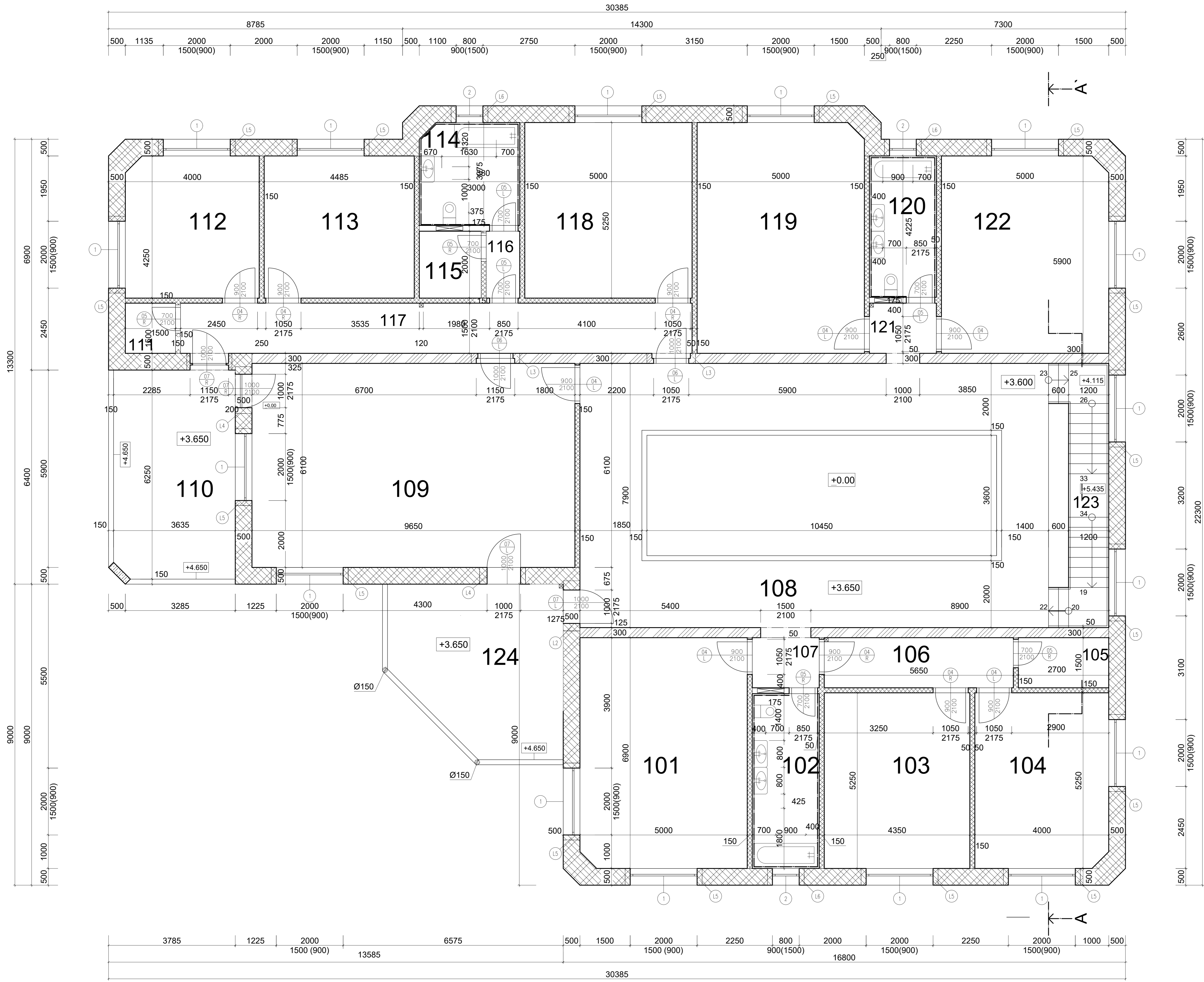

## Description of the rooms

Number	Name	Floor Surface	Area [m <sup>2</sup> ]	Wall Surface
101	Bedroom	Marble	34.37	Plaster
102	Bathroom	Ceramic Tiles	10.45	Ceramic
103	Bedroom	Marble	22.84	Plaster
104	Bedroom	Marble	20.87	Plaster
105	Cloth storage	Ceramic Tiles	4.05	Plaster
106	Corridor	Marble	8.47	Plaster
107	Corridor	Marble	3000000	Plaster
108	Corridor	Marble	66.92	Plaster
109	Bedroom	Marble	58.86	Plaster
110	Balcony	Ceramic Tiles	22.59	Plaster
111	Technical Room	Fine Concrete	2.25	Plaster
112	Bedroom	Marble	16.88	Plaster
113	Bedroom	Marble	18.97	Plaster
114	Bathroom	Ceramic Tiles	9.10	Ceramic
115	Technical Room	Fine Concrete	3.70	Plaster
116	Corridor	Marble	1.99	Plaster
117	Corridor	Marble	22.93	Plaster
118	Bedroom	Marble	26.25	Plaster
119	Bedroom	Marble	34.38	Plaster
120	Bathroom	Ceramic Tiles	8.42	Ceramic
121	Corridor	Marble	3.00	Plaster
122	Bedroom	Marble	29.38	Plaster
123	Staircase	Marble	10.91	Plaster
124	Balcony	Ceramic Tiles	23.89	Plaster
Sum			464.48	

- L1: Lintel Ytong NOP 375-2500
- L2: Lintel Ytong NOP 375-1750
- L3: Lintel Ytong NOP 300-1750
- L4: Lintel Ytong NOP 375-1500
- L5: Lintel Ytong 2x YQ U Profile 225
- L6: Lintel Ytong NOP 375-1300

- Ytong Lambda QY 500, P2.2
- Ytong Statik 300, P5
- Ytong Klasik 150, P2.8
- Reinforced Concrete

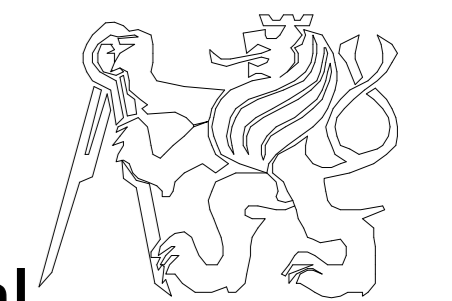
Student: <b>Ahmed Alshawi</b>	Supervisor: <b>Doc. Ing. Frantisek Kulhanek, CSc.</b>	 <b>Czech Technical University in Prague</b>
Subject: <b>Diploma Project</b>	Academic Year: <b>2018/2019</b>	
Title: <b>First Floor</b>		Scale: <b>1:50</b>
		No. of Drawing: <b>03</b>