

# STRUCTURAL VARIANT 2

First floor, M 1:200

SECTION

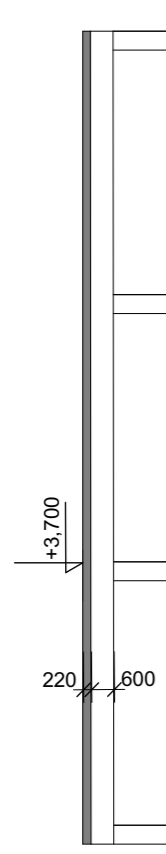

PLAN

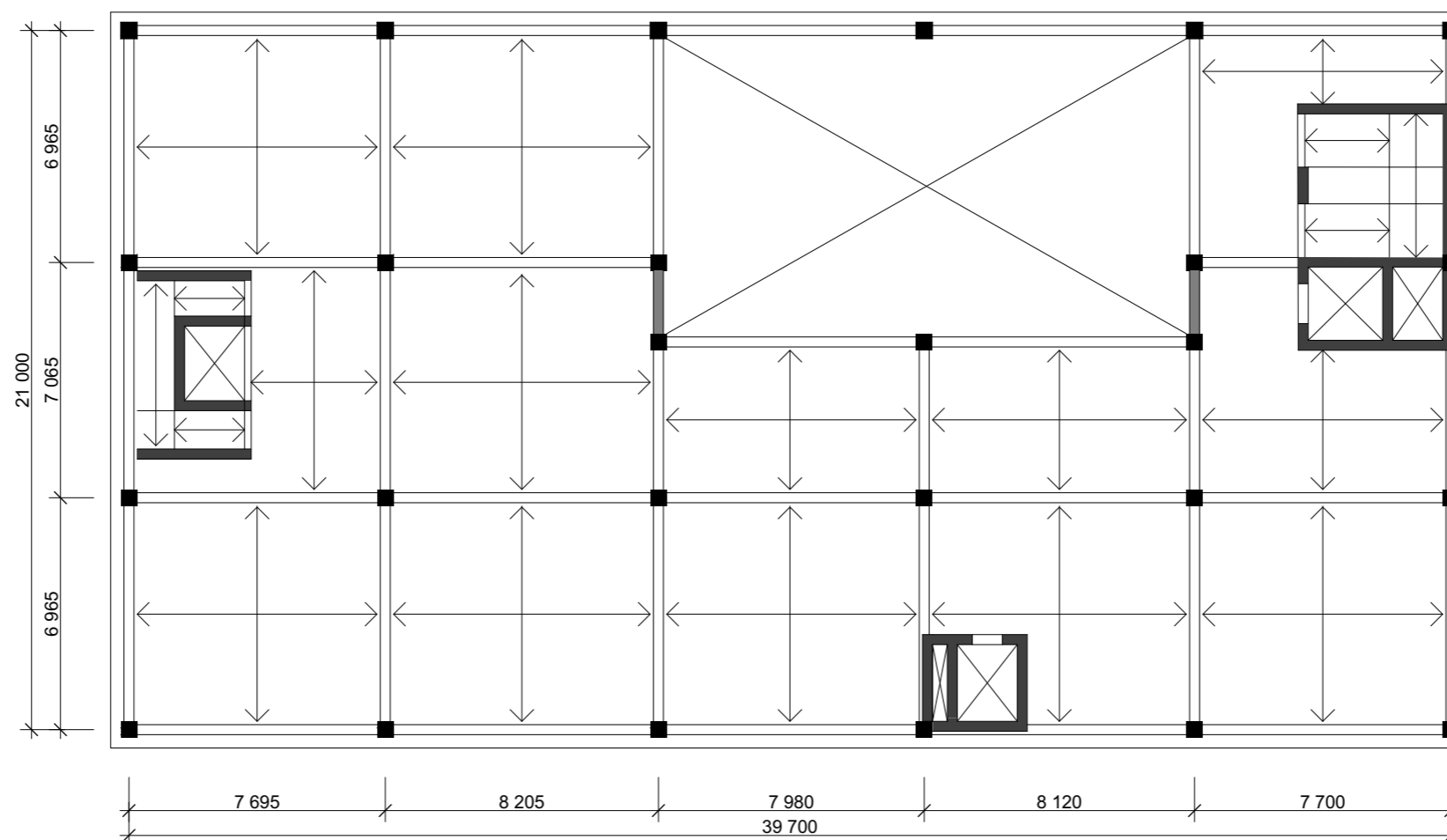

## Description:

Two way column system with girders and two way slab  
 maximum span is 8,2 m between columns  
 two way slab continuously supported over the girders is used as ceiling structure  
 girders can be designed as hidden in massive ceiling structure with lost form work from boxes  
 stiffening walls in both direction are used to avoid tension in the foot  
 whole structure is from reinforced concrete, walls can be from masonry  
 curtain wall is used as envelope of the whole building  
 max variable load is 7,5 kN/m<sup>2</sup>  
 dimensions of the structural members are empirically estimated

N

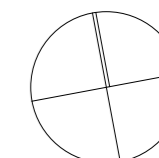

±0,000 = 253,057 m. Bpv.

 CTU IN PRAGUE	Student	Supervisor	Format	2xA4
	Martin Vaniček	doc. Ing. Vladimír Žďára, CSc. Department of Building Structures	Date	27.5.2017
	Building	Municipal library of Kutná Hora BACHELOR PROJECT	School year	2016/2017
	Content	Structural variant 2	SEMESTER	SUMMER
			SCALE	DRAWING NO.
			1:200	02