

Optimum Series

Narrow bodied high performance displacement sensors

Description

The Optimum Series of LVDT sensors is an ideal choice for process control and research applications. The free core variants are designed for precise linear positioning and measurement of moving parts where zero friction and hysteresis is required within a restricted space.

The free core version is available with an optional lightweight core for mounting on to small, rapidly moving structures without affecting their performance and integrity, which is important in some control applications.

A version of a lightweight core with a 1.9 mm diameter is available which improves core to bore clearance, making alignment easier. A light titanium core carrier can be supplied on request.

The optimum is also available as a guided product and with universal joints either as an LVDT or digital product for use in applications where it is not possible to mount the core and carrier on the moving part.

Features

- Good measurement range to body length ratio
- Small body diameter
- Larger radial bore clearance
- Rugged construction
- High temperature (200 °C) available on request
- High pressure (vented case) available



Precision. Quality. Reliability

www.solartronmetrology.com • sales.solartronmetrology@ametek.com

Technical Specification

Generic Product Types

| | | | | | |
|------------------------|-------|------|------|--------|------|
| LVDT | OP1.5 | OP6 | OP10 | OP12.5 | OP25 |
| Digital Output (Orbit) | DO3 | DO12 | DO20 | DO25 | DO50 |

Measurement

| | | | | | |
|--|-------|-------|-------|-------|-------|
| Measurement Range LVDT (mm) | ±1.5 | ±6 | ±10 | ±12.5 | ±25 |
| Measurement Range ORBIT (mm) | 3 | 12 | 20 | 25 | 50 |
| Linearity (% FSO) | <0.25 | <0.25 | <0.25 | <0.25 | <0.25 |
| Resolution µm (Note 1) | <0.10 | <0.10 | <0.10 | <0.20 | <0.40 |
| Pre-travel ±0.5 mm (Guided Versions only) | 1.78 | 1.53 | 1.53 | 2.33 | 2.10 |
| Post Travel ±0.5 mm (Guided Versions only) | 1.20 | 1.67 | 1.67 | 2.47 | 2.30 |
| Temperature Coefficients (%FSO/°C) LVDT | <0.05 | <0.05 | <0.05 | <0.05 | <0.05 |
| Temperature Coefficients (%FSO/°C) DC/4-20mA | <0.07 | <0.07 | <0.07 | <0.07 | <0.07 |
| Tip Force ±20% (Horizontal at middle of range) N | 0.66 | 0.94 | 0.94 | 0.93 | 0.50 |

Mechanical

| | | | | | |
|---|----------------------------|-----|-----|-----|-----|
| Nominal Mass (g) LVDT | 7 | 12 | 12 | 20 | 20 |
| Nominal Mass of Core (g) | 1.5 | 2.5 | 2.0 | 3.5 | 4.0 |
| Body diameter (mm) | 9.52 | | | | |
| Case material | 400 Series Stainless Steel | | | | |
| Core material | Nickel Iron | | | | |
| Cable Standard Type/Length (m) (Note 2) | F.E.P. / 3 Style A or B | | | | |

Electrical Interface (LVDT)

| | | | | | |
|------------------------------------|-----|-----|--------------------|-----|------|
| Energising Voltage (Vrms) at 5 kHz | 1-5 | | | | |
| Energising Current at 5kHz (mA/V) | 6.0 | 4.5 | 3.2 ⁽³⁾ | 7.0 | 1.25 |
| Sensitivity at 5kHz ±5% mV/V/mm | 108 | 78 | 85 ⁽³⁾ | 67 | 25 |

Electrical Interface (ORBIT)

| | |
|------------------------|--|
| Bandwidth | Up to 460 Hz (selectable) Solartron Orbit 5±0.25 @ 0.06A IP43 |
| Output | |
| Power (VDC) | |
| Sealing (Orbit Module) | |

Environment

| | |
|----------------------------|--------------|
| Operating Temperature (°C) | -40 to +150 |
| Storage Temperature (°C) | -40 to +150 |
| Sealing | Splash Proof |

Note 1: Resolution specification is only applicable to ORBIT digital transducers.

The resolution of LVDT transducers is effectively infinite and is only limited by the conditioning electronics

Note 2: Cable Style A comprises of individual twisted cores , Style B comprises a sheathed and screened cable

Note 3: OP10 at 20 kHz

OP Series Dimensions

Free Core

| Type | A | B | C (at Null) |
|--------|-------|-------|-------------|
| OP1.5 | 20.60 | 11.00 | 4.80 |
| OP6 | 46.50 | 28.40 | 9.05 |
| OP10 | 46.50 | 20.40 | 13.05 |
| OP12.5 | 83.50 | 50.80 | 16.35 |
| OP25 | 83.50 | 26.00 | 28.75 |

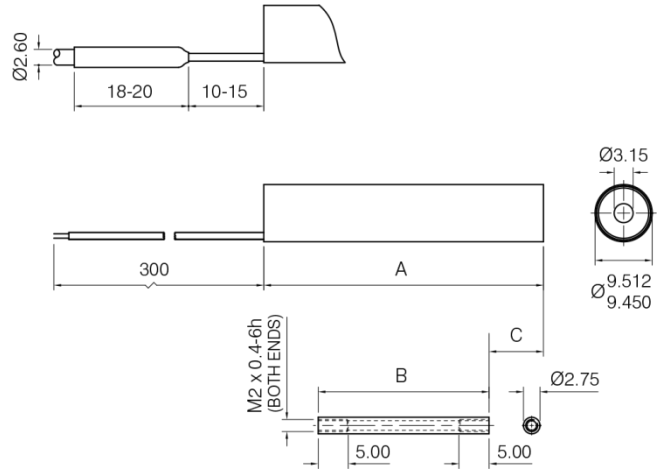

Guided Core & Universal Joints

| Type | A | B (at Null) |
|--------|-------|-------------|
| OP1.5 | 20.60 | 14.00 |
| OP6 | 46.50 | 20.90 |
| OP10 | 46.50 | 29.40 |
| OP12.5 | 83.50 | 31.50 |
| OP25 | 83.50 | 48.65 |

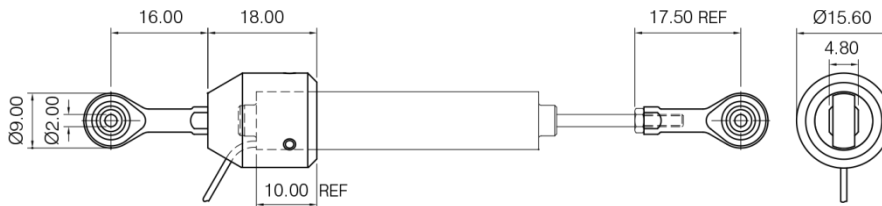
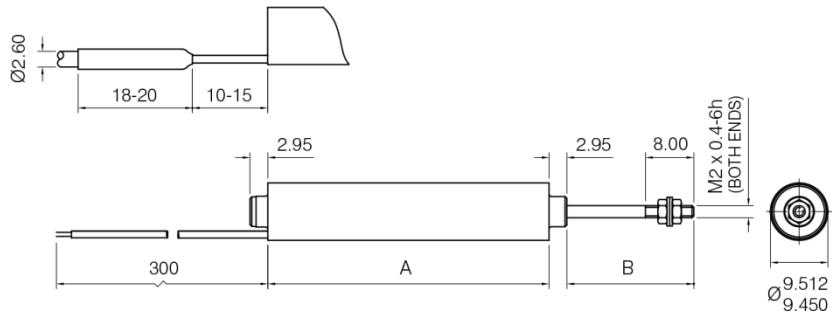

For 3D drawings, please contact sales.solartronmetrology@ametek.co.uk

United Kingdom - Head Office

Solartron Metrology
Steyning Way
Bognor Regis
West Sussex
PO22 9ST
Tel: +44 (0) 1243 833333
Fax: +44 (0) 1243 833322
Sales.solartronmetrology@ametek.com

France

Solartron Metrology
Rond-point de l'Espine des Champs
Buroplus - Bat. D
Elancourt 78990
Tel: +33 (0)1 30 68 89 50
Fax: +33 (0)1 30 68 89 59
france.solartronmetrology@ametek.com

Germany

Ametek GmbH
Solartron Metrology Division
Rudolf-Diesel-Strasse 16
40670 Meerbusch
Tel: +49 (0) 2159 9136 500
Fax: +49 (0) 2159 9136 505
vertrieb.solartron@ametek.de

Brazil

Ametek do Brasil, Ltda
Rod. Eng Ermenio de Oliveira Penteadou, Km 57, SP75
Bairro Tombadouro
13337-300, Indaiatuba, SP, Brazil
Tel: +55 19 2107 4126

India

Ametek Instruments India Private Limited
1st Floor, Left Wing
Prestige Featherlite Tech Park
Plot #148, EPIP II Phase
Whitefield, Bengaluru 560 066
Karnataka, India
Tel: +91 80 6782 3200
Fax: +91 80 6782 3232

USA

Solartron Metrology
USA Central Sales Office
915 N.New Hope Road, Suite C
Gastonia, NC 28054
Tel: +1 800 873 5838
Fax: +1 704 868 8466
usasales.solartronmetrology@ametek.com

China

AMETEK Commercial Enterprise (Shanghai) Co. Ltd
No. 155 Puhui Road
Ju Ting Economic Development Zone
Shanghai 200131, China
Tel: +86 21 5763 2509
Fax: +86 21 5866 0969 Ext. 261/262
china.solartronmetrology@ametek.com



**Solartron
Metrology**

Precision Driven

Offices worldwide
Agent and distributor details
available at
www.solartronmetrology.com



Q09540

Solartron pursues a policy of continuous development. Specifications in this document may therefore be changed without notice.

AMETEK[®]
ULTRA PRECISION TECHNOLOGIES

Precision. Quality. Reliability

www.solartronmetrology.com • sales.solartronmetrology@ametek.com